

CONTAINER LOCKING CASTOR KIT

These kits once fitted to each castor, are then mounted onto each corner of the container, thus making the container mobile.

Fitting requires using two left-hand and two right-hand kits.

Using 3000 Series castors allows a maximum total of 12 tonne loading at 8KPH and EHP castors will allow 20 tonne loading. Please note some castors in each range have lower capacities and this must be allowed for.

Shipping containers have 2 left and right fittings, so to order the correct fittings to move a container, order 2 x 195CONT-LOCKITL, 2 x 195CONT-LOCKITR and 4 x castors.



KIT CONTENTS

- 1 x Left or right corner fitting
- 1 x Locating bush
- 1 x M30 bolt
- 1 x Flat washer
- 4 x M30 Spring washers & fasteners

To move a container order 2 x 195CONT-LOCKITL, 2 x 195CONT-LOCKITR + 4 castors.



5000kg capacity kit using EHP Series



3000kg capacity kit using 3000 Series



CONTAINER LOCKING CASTOR ASSEMBLY INSTRUCTIONS

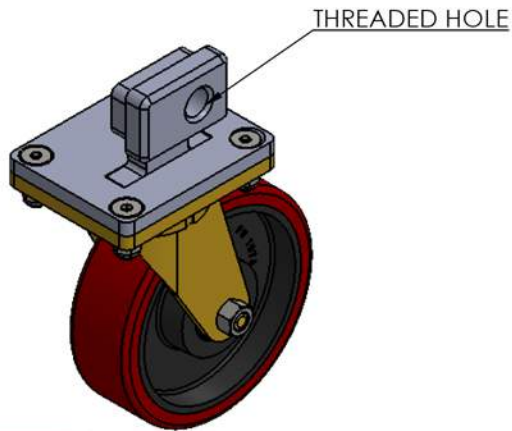

FRONT RIGHT / REAR LEFT CONTAINER CASTOR
NOTE THE THREADED HOLE POSITION

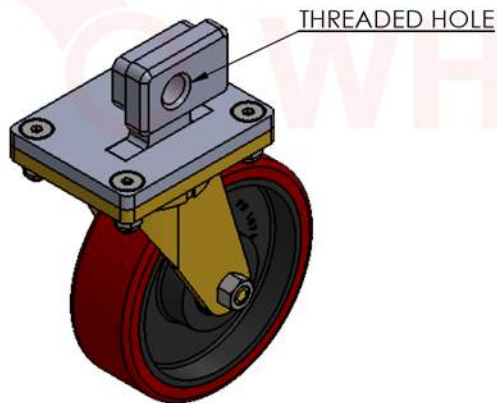

FRONT LEFT / REAR RIGHT CONTAINER CASTOR
NOTE THE THREADED HOLE POSITION

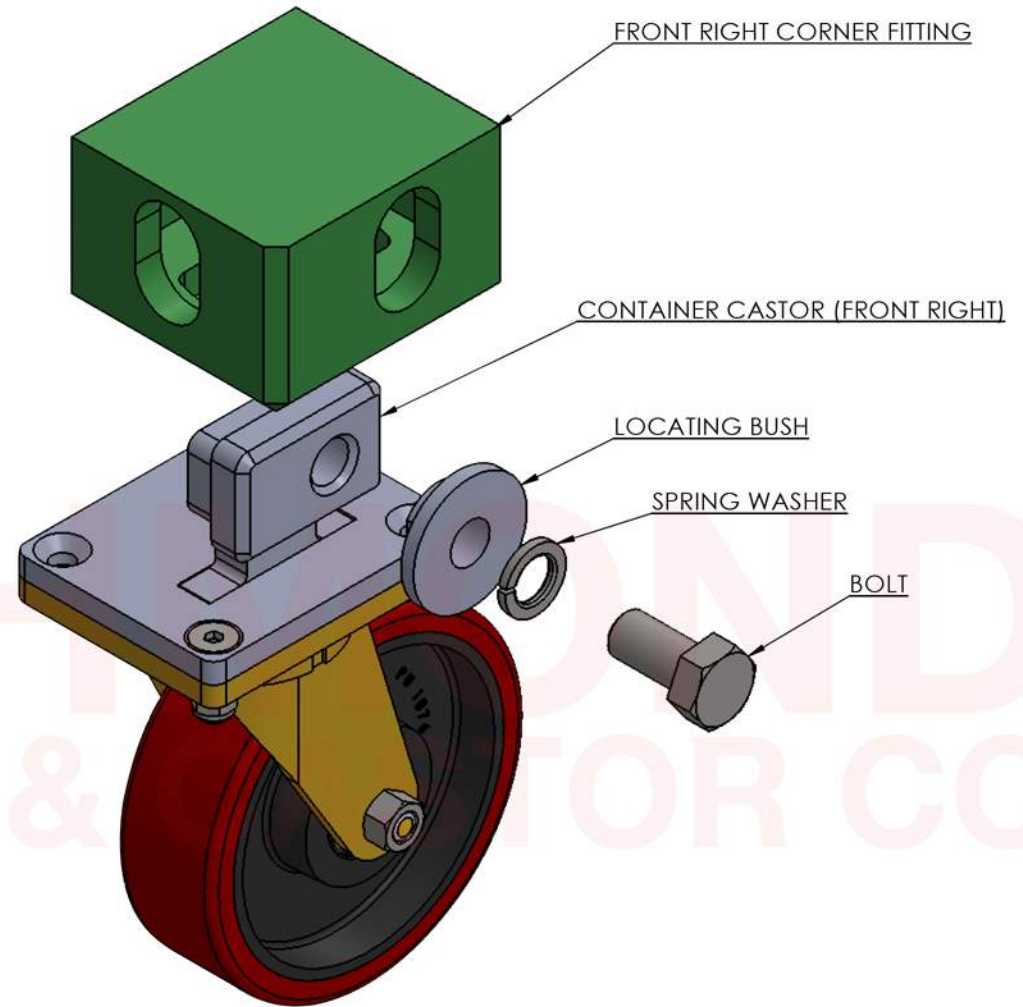

PROPRIETARY AND CONFIDENTIAL
THE INFORMATION CONTAINED IN THIS DRAWING IS THE SOLE PROPERTY OF Richmond Wheel & Castor Co. ANY REPRODUCTION IN PART OR AS A WHOLE WITHOUT THE WRITTEN PERMISSION OF Richmond Wheel & Castor Co. IS PROHIBITED.

	NAME	SIGNATURE	DATE
DRAWN	TOM	TM	26/08/2013
CHK'D	SY	SY	26/08/2013
APP'V'D	RAY	RW	26/08/2013
MFG	SY	SY	26/08/2013
Q.A	BARRY	BN	26/08/2013

UNLESS OTHERWISE SPECIFIED:
DIMENSIONS ARE IN MILLIMETERS
TOLERANCES TO 0.25MM

DEBUR AND
BREAK SHARP
EDGES



DO NOT SCALE DRAWING	REVISION	FINISH:
TITLE: RICHMOND WHEEL & CASTOR CO.		
DWG NO 195CONT-LOCKIT ASSEM PROCEDURE		A3
SHEET 1 OF 2		

195CONT-LOCKITR ASSEMBLY INSTRUCTIONS

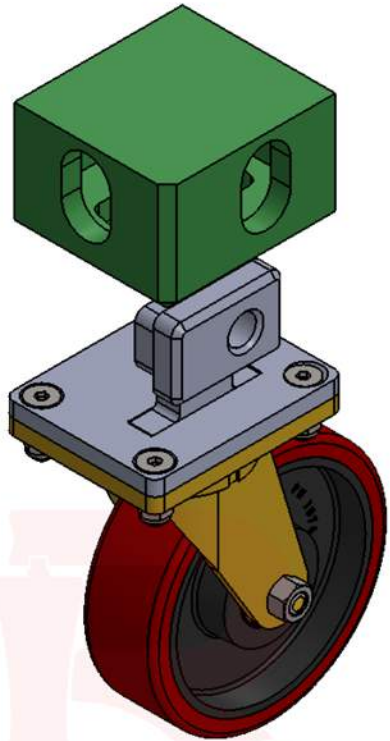

STEP 1: POSITION CASTOR UNDER CORNER FITTING AND INSERT CONTAINER CASTOR

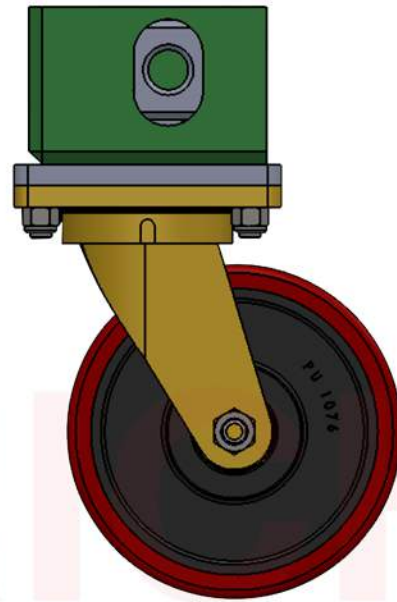

STEP 2: ALIGN THREADED HOLE WITH SLOT IN CORNER FITTING

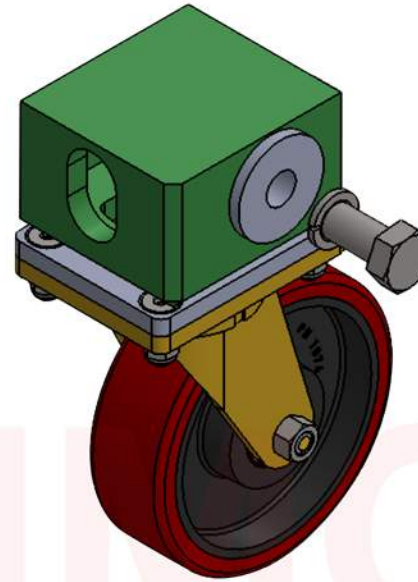

STEP 3: INSERT BUSH

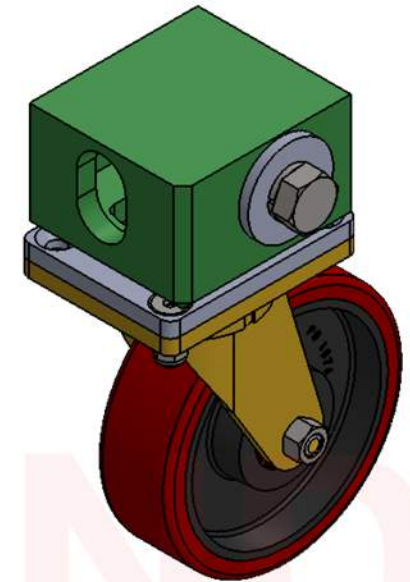

STEP 4: ASSEMBLY SPRING WASHER AND BOLT AND TIGHTEN UNTILL FIRM

PROPRIETARY AND CONFIDENTIAL
 THE INFORMATION CONTAINED IN THIS DRAWING IS THE SOLE PROPERTY OF Richmond Wheel & Castor Co. ANY REPRODUCTION IN PART OR AS A WHOLE WITHOUT THE WRITTEN PERMISSION OF Richmond Wheel & Castor Co. IS PROHIBITED.

	NAME	SIGNATURE	DATE
DRAWN	TOM	TM	26/08/2013
CHK'D	SY	SY	26/08/2013
APP'V'D	RAY	RW	26/08/2013
MFG	SY	SY	26/08/2013
Q.A	BARRY	BN	26/08/2013

UNLESS OTHERWISE SPECIFIED:
 DIMENSIONS ARE IN MILLIMETERS
 TOLERANCES TO 0.25MM

DEBUR AND BREAK SHARP EDGES



DO NOT SCALE DRAWING	REVISION	FINISH:
TITLE: RICHMOND WHEEL & CASTOR CO.		
DWG NO 195CONT-LOCKITR ASSEM PROCEDURE	A3	

WEIGHT:

SHEET 2 OF 2